

No need to stop MACHINES



Centralised Automatic Lubrication Systems & Greasing SPM, Oiling SPM, for Auto Industries and Others..

A Source of Complete Oil & Grease Lubrication Solutions



Managing Director



COMPANY PROFILE (Since 2009)

Lubsa Multilub Systems Pvt. Ltd. is one of the extra ordinary manufacturers of Oil & grease Lubrication Systems & Hydraulic power pack & other assembly metric pump for enabling plant, special purpose machine for greasing, oiling application & Other P.V.C. liquid pump for bottle food packing cover in national & international markets. We are an **ISO 9001:2015 certified organization**. The most important fact about the firm is that they always wishes to do extraordinary compared to other firms. This fact mostly keeps them ahead of their competitors by a huge margin. Apart from the quality products manufacturing firm also keeps their rates very reasonable so that nobody has to choose between quality & prices. We are believed on the product quality and client satisfaction. The honorable Managing Director Mr. **A. K.Yadav** is very dynamic and dedicated persons with high level of determination.

Leveraging on our manufacturing facility, we are able to fabricate a wide range of centralized lubrication system for meeting the requirements of oil and grease in diverse industries.

Furthermore, we also have with us an experienced team who assist us in designing and developing our range as per the specific requirements of the customers. With the help of our expert team, we are providing erection and commissioning services to our customers. The best value is also enhanced by **Lubsa** wide customer service network guaranteed fast delivery, rapid response, local back-up, as well as by wide service network supporting the after sales service.

- PROLONGED LIFE OF MACHINE.
- MORE PRODUCTION.
- MORE RELIABILITY.
- NO HUMAN ERROR.
- OPTIMUM LUBRICANT TO EACH POINT.
- LESS CONSUMPTION OF LUBRICANT.
- LOW NOISE LEVEL.
- LESS POWER CONSUMPTION.
- LESS WEAR & TEAR.
- SAFE NO NEED TO STOP MACHINE.

DESIGN FACILITY - SOLID WORK SOFTWARE

Centralised lubrication system can be adopted on any machine particularly:-

- ◆ Machine Tools
- ◆ Textile machines
- ◆ Packaging equipment
- ◆ Presses and Hammers
- ◆ Pulp & paper processing machines
- ◆ Food Processing equipment
- ◆ Wood working machine
- ◆ Knitting machine
- ◆ Pharmaceutical machines
- ◆ Stone processing machines
- ◆ Printing machine
- ◆ Forzing plants
- ◆ SPM machine
- ◆ Injection/Blow moulding machine
- ◆ Pouch malcium/filling machine
- ◆ Bottle forming /filling washing machine
- ◆ Sheet metal working machine
- ◆ Shearing and press brakes
- ◆ Die casting machine
- ◆ Rubber making machine
- ◆ Metal forms machine
- ◆ Calendering machine
- ◆ Cement plants
- ◆ Sugar plants
- ◆ Rolling mill machine
- ◆ Wire drowing machine

INSTALLATION LAYOUT

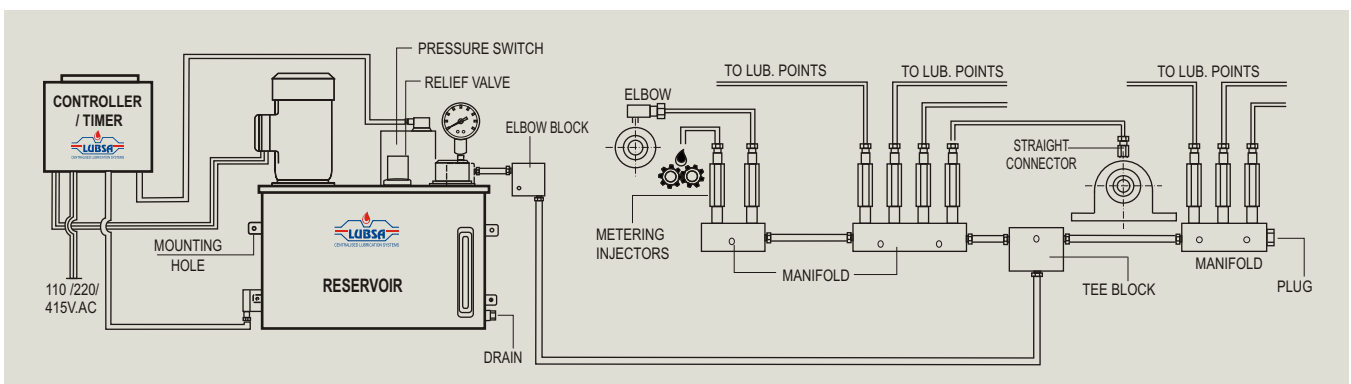

Vendor registration, email : akyadav@lubsa.co.in

MOTOR PUMP ASSEMBLY

Motor pump assembly is used for oil lubrication especially where continuous and high dosage of oil is required. It is also applied under oil circulation systems. It is used almost in all machines where free flow of oil is required. The different specification is available with different model. The rotation of motor pump assembly is indicated on the label. Four mounting holes are provided to mount the system.

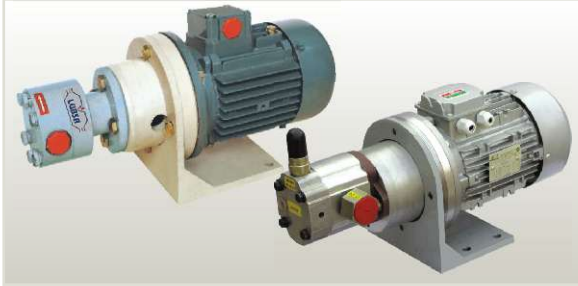

Technical Specification

| MODELS | Discharge | Max. Pressure | Motor Flange Mounted |
|----------|----------------------|----------------------|---------------------------|
| LMP - 1 | 1 Litres per minute | 25Kg/Cm ² | 0.25 HP, 415V, AC1500rpm. |
| LMP - 3 | 3 Litres per minute | 20Kg/Cm ² | 0.25 HP, 415V, AC1500rpm. |
| LMP - 6 | 6 Litres per minute | 15Kg/Cm ² | 0.50 HP, 415V, AC1500rpm. |
| LMP - 10 | 10 Litres per minute | 12Kg/Cm ² | 1.00 HP, 415V, AC1500rpm. |
| LMP - 16 | 16 Litres per minute | 10Kg/Cm ² | 1.50 HP, 415V, AC1500rpm. |
| LMP - 25 | 25 Litres per minute | 8Kg/Cm ² | 2.00 HP, 415V, AC1500rpm. |
| LMP - 40 | 40 Litres per minute | 5Kg/Cm ² | 3.00 HP, 415V, AC1500rpm. |

ROTARY PUMPS

ROTARY PUMPS are gerotor type pumps with positive displacement of oil. On the basis of construction they are of two types, flange type and insert type. Function wise these pumps can be classified into two types non reversible and reversible. Non reversible pumps are rotates only on one direction indicated by an arrow where as the reversible pumps are rotates on either direction, clock-wise and anti-clock-wise.



FLANGE MOUNTING ROTARY PUMPS (Non Reversible / Reversible)

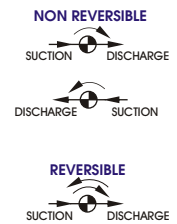
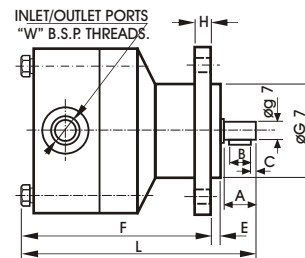
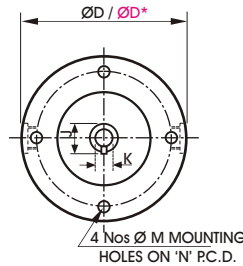

Dimensions in mm

| MODEL | Discharge at 1500 RPM | A | B | C | ØD / ØD* | Ød | E | F | ØG | H | J | K | L | M | N | "W" in BSP |
|---------|-----------------------|----|----|---|-----------|----|---|-----|----|----|------|---|-----|-----|------|------------|
| LRP-0.5 | 0.5 LPM | 16 | 12 | 2 | 50 / 60 | 7 | 2 | 55 | 30 | 5 | 9 | 2 | 71 | 5 | 39 | 1/8 |
| LRP-1 | 1 LPM | 22 | 16 | 3 | 60 / 70 | 10 | 2 | 70 | 35 | 7 | 11.5 | 3 | 95 | 6.5 | 47.5 | 1/4 |
| LRP-3 | 3 LPM | 22 | 16 | 3 | 60 / 70 | 10 | 2 | 75 | 35 | 7 | 11.5 | 3 | 100 | 6.5 | 47.5 | 1/4 |
| LRP-6 | 6 LPM | 30 | 18 | 6 | 80 / 92 | 12 | 3 | 95 | 45 | 10 | 14 | 4 | 130 | 8.5 | 65 | 1/4-3/8 |
| LRP-10 | 10 LPM | 30 | 18 | 6 | 80 / 92 | 12 | 3 | 105 | 45 | 10 | 14 | 4 | 140 | 8.5 | 65 | 1/4-3/8 |
| LRP-16 | 16 LPM | 40 | 25 | 7 | 115 / 135 | 14 | 4 | 120 | 65 | 14 | 16 | 5 | 165 | 9 | 95 | 1/2" |
| LRP-25 | 25 LPM | 40 | 25 | 7 | 115 / 135 | 14 | 4 | 135 | 65 | 15 | 16 | 5 | 180 | 9 | 95 | 3/4" |
| LRP-40 | 40 LPM | 40 | 25 | 7 | 115 / 135 | 14 | 4 | 150 | 65 | 15 | 16 | 5 | 200 | 9 | 95 | 1" |



INSERT TYPE ROTARY PUMPS (Non Reversible / Reversible)

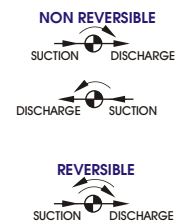
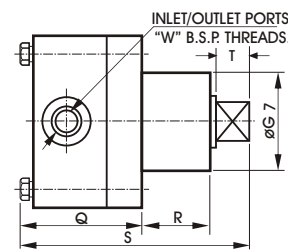
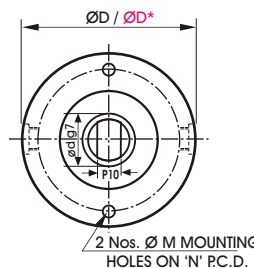

Dimensions in mm

| MODEL | Discharge at 1500 RPM | ØD / ØD* | Ød | ØG | M | N | P | Q | R | S | T | "W" in BSP |
|--------|-----------------------|----------|----|----|-----|------|---|----|----|-----|----|------------|
| LRP-1 | 1 LPM | 60 / 70 | 10 | 35 | 6.5 | 47.5 | 6 | 48 | 24 | 83 | 10 | 1/4 |
| LRP-3 | 3 LPM | 60 / 70 | 10 | 35 | 6.5 | 47.5 | 6 | 53 | 24 | 88 | 10 | 1/4 |
| LRP-6 | 6 LPM | 80 / 92 | 12 | 45 | 8.5 | 65 | 7 | 65 | 33 | 103 | 12 | 1/4-3/8 |
| LRP-10 | 10 LPM | 80 / 92 | 12 | 45 | 8.5 | 65 | 7 | 75 | 33 | 122 | 12 | 1/4-3/8 |



AN ISO 9001-2015 CO.



Registered With
NSIC
CERTIFIED CO.



CENTRALISED LUBRICATION SYSTEMS

A SOURCE OF COMPLETE OIL /GREASE EQUIPMENTS RESEARCH & DEVELOPMENT CENTRE

LUBSA MULTILUB SYSTEMS (P) LIMITED

(An ISO 9001:2015 Certified Company)

Head Office : (All corresponding address)

Plot No. 1870, DC, Dabua Gajipur Road, (Near Bhardwaj Medical Store)
N. I. T. FARIDABAD-121001 (HR) INDIA Mob. : 9212566247 (akyadav@lubsa.co.in)
9717190247 (info@lubsa.co.in), 9871496247 (sales@lubsa.co.in) (Sunday- Closed)

Manufacturing plant

Plot No. 1- 6 & 67-71 Village Bajri, Near Pali Chowk, Front of petrol pump,
Ballabgarh Sohna Road, N.I.T. FARIDABAD-121001 (Haryana) INDIA
Mob. : 9899451247, ,9871496247 E-mail : lubsa1981@gmail.com
Website : www.lubsa.co.in, lubsalubsystems.com (Sunday- Closed)



Google Maps

Note : Specifications are subject to be changed without any notice.

CUSTOMERS' CARE No. 9899451247